



4G – VoLTE (Voice over LTE) Lift Call Line

ALPHATECH TECHNOLOGIES s.r.o.

producer of emergency lift intercom systems

<https://www.alphatechtechnologies.cz/>





4G Lift Call Line

- 2G / 4G (VoLTE) – Voice over LTE version
- Meets all safety standards for elevators / lifts
 - EN 81-28+AC:2019-04, 81-70
- Easy installation – just a 2-wire connection
- Easy setup - basic settings with a single SMS text message





4G Lift Call Line

Typical scenario: emergency voice connection from the lift cabin / elevator car with the emergency service, fire brigade, police, operator, etc.

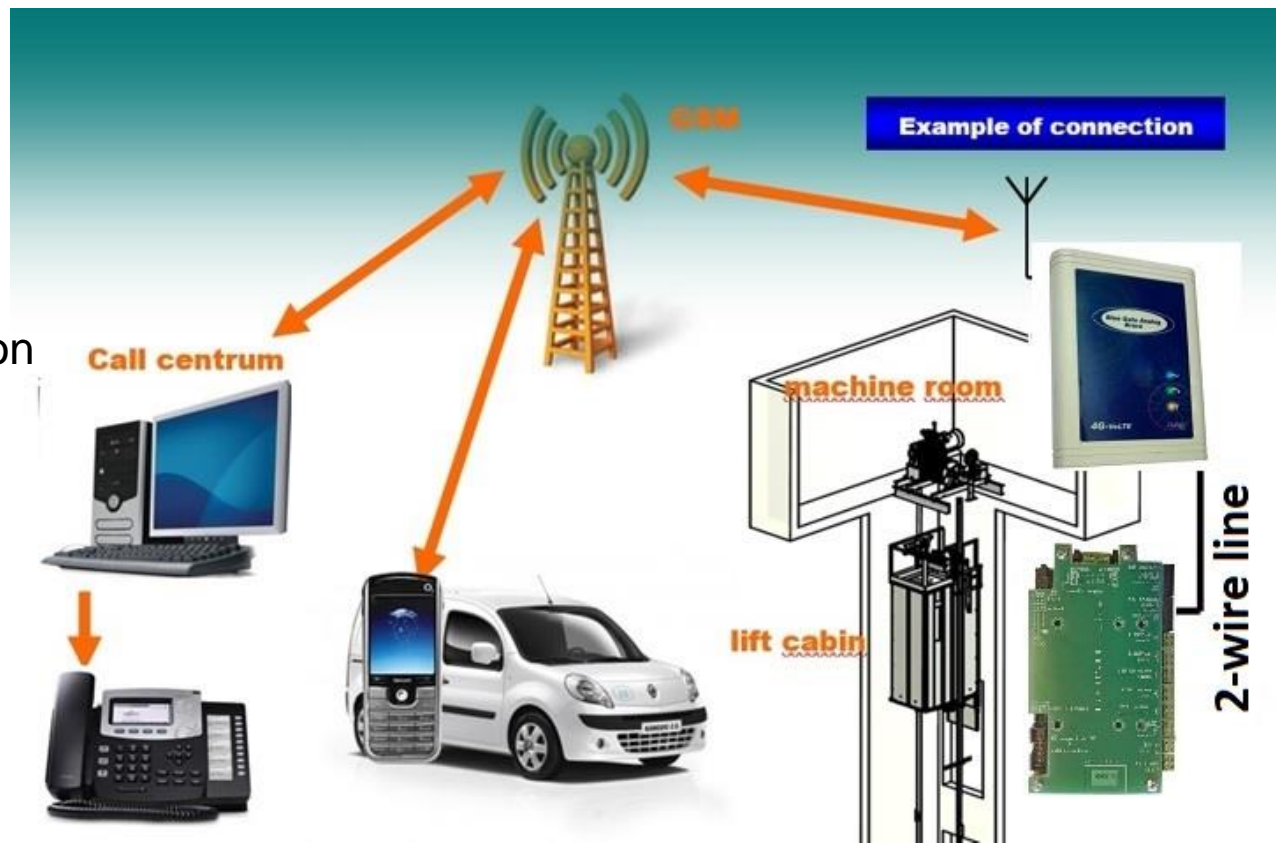



4G Lift Call Line

- The Alphatech Lift Call Line emergency intercom
 - To be installed inside the lift cabin / elevator car
 - Mounted behind the front emergency call panel
 - Connected to the emergency call button of the front panel
 - Simple 2-wire connection to the Alphatech 2G/4G GSM gateway
 - Easy basic DTMF programming via a single SMS text message received from the Alphatech 4G gateway

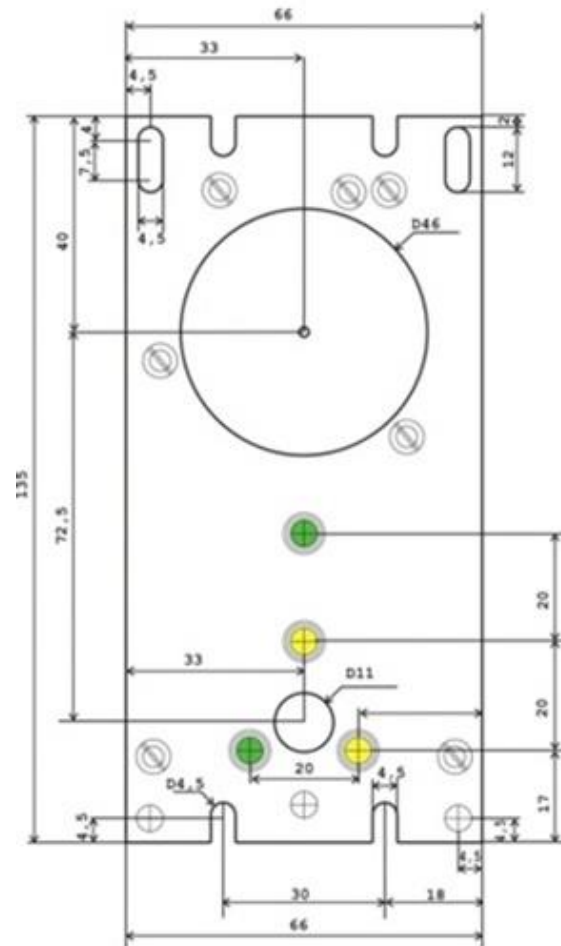



4G Lift Call Line

- The Alphatech Lift Call Line emergency intercom
 - 2x RJ45 port for UTP cable connection
 - to the LCL-SPK MIC/SPK unit above the elevator car
 - to the LCL-SPK MIC/SPK unit under the elevator car
 - The special UTP cable is always delivered with the LCL-SPK unit





4G Lift Call Line

- The Alphatech 2G/4G (VoLTE – Voice over LTE) GSM gateway
 - To be installed in the machine room
 - SMS feature of the 4G gateway for easy programming of the Lift Call Line intercom
 - 2-wire connection to the Alphatech Lift Call Line inside the lift cabin / elevator car
 - The 4G gateway needs just a power supply adapter, GSM antenna, SIM card
 - No programming of the gateway is required
 - Optional battery backup inside the gateway

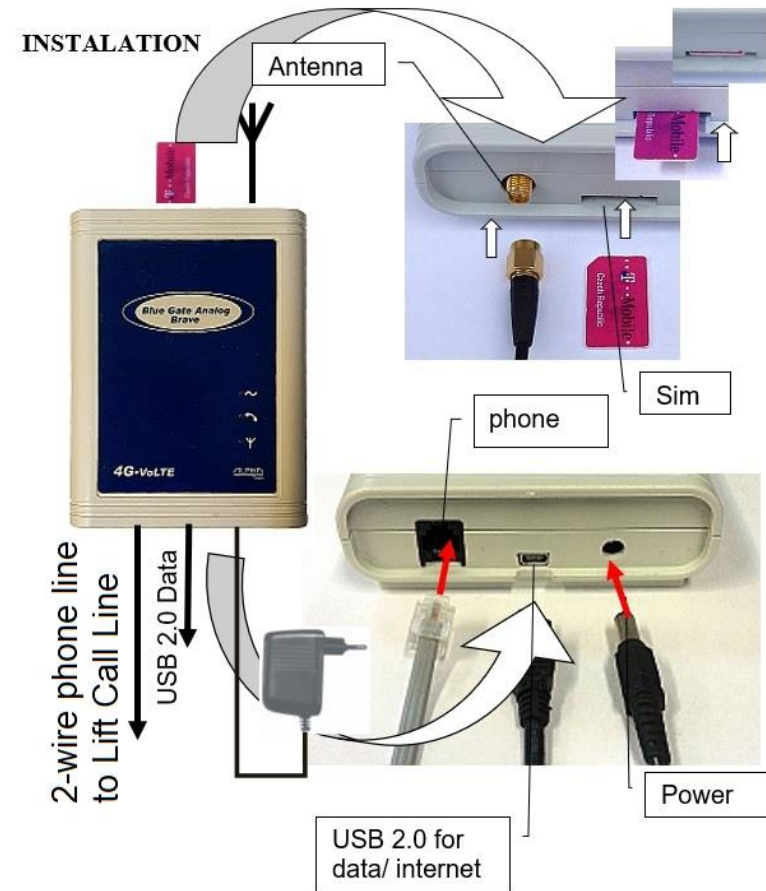



4G Lift Call Line

- Typical installation of the Lift Call Line and the 4G gateway
- 2-wire phone line connection
- Programmed via one SMS text message
- The 4G gateway requires no programming
- The 4G gateway has an integrated SMS programming function
 - for the connected Lift Call Line intercom
 - with just a single SMS text message you can program the Lift Call Line intecom

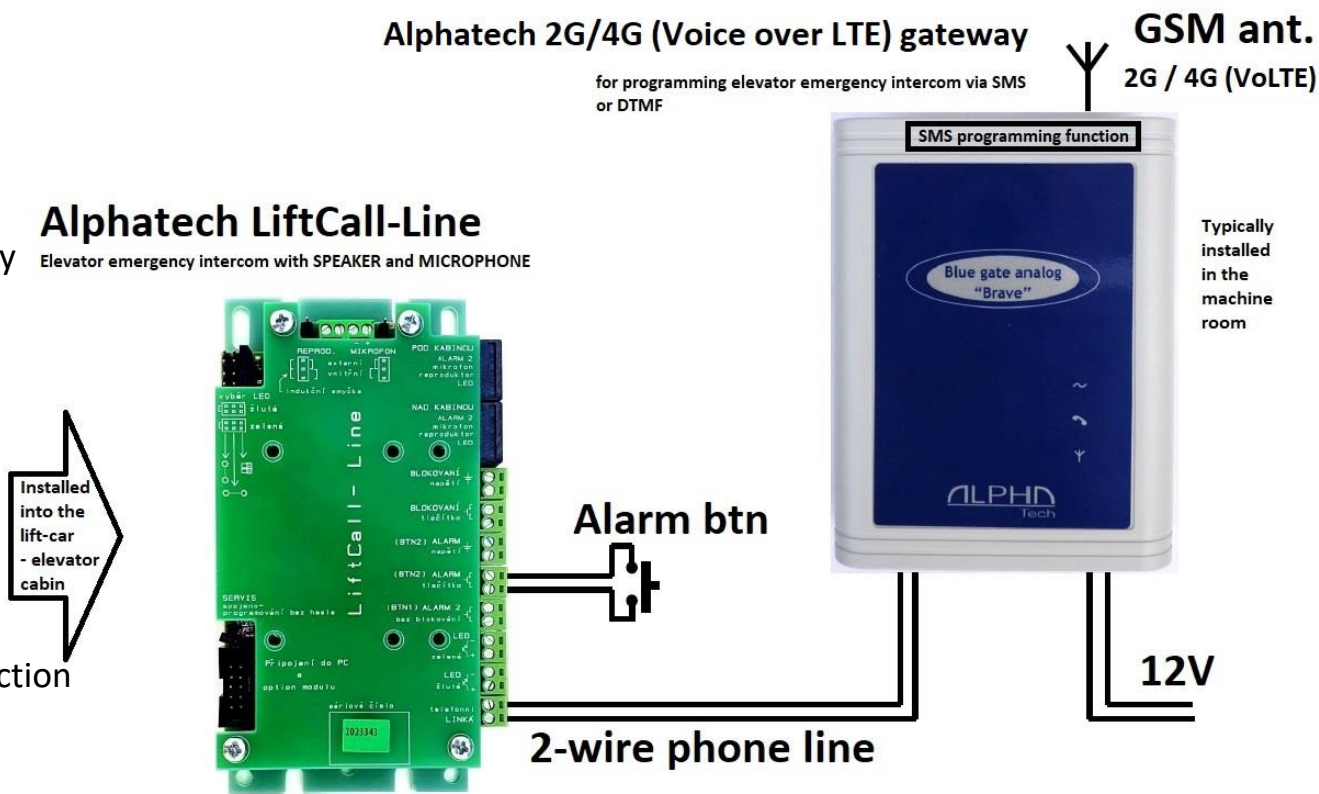



4G Lift Call Line

- Optionally external LEDs (GREEN/YELLOW) with cables
- Optionally EP14 voltage reduction device
 - In case you have your own power supply
 - EP14 deducts 14V from your power supply
 - when powered from your own 24V source
 - Max. current approx. 500mA
 - DC connector for connection to the 4G gateway
 - Red wire is the + positive polarity, 1m wires

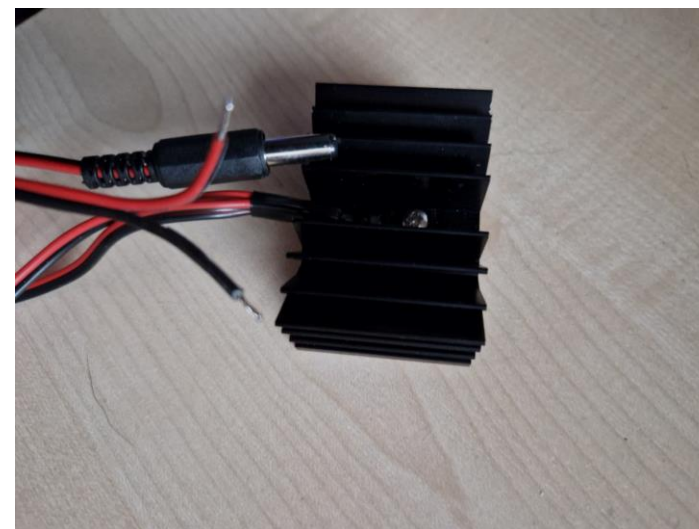
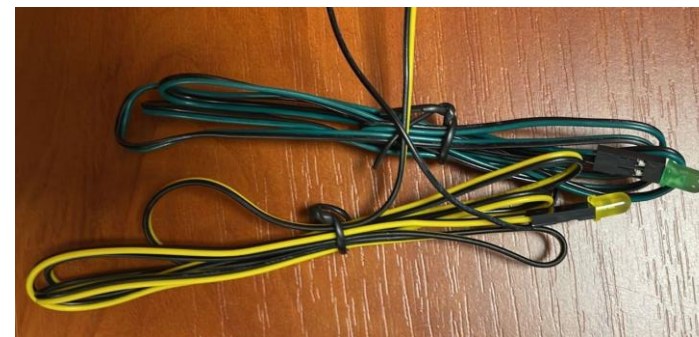



4G Lift Call Line

- The optional Inductive Loop amplifier unit is installed inside the lift cabin / elevator car
- It's installed behind the lift/elevator front panel with the emergency call button
- It's used by impaired hearing persons
- Parallel connection to the Lift Call Line intercom in the lift cabin
 - correct setting of the jumpers on the Lift Call Line intercom is required
- 9-28VDC external power supply is required

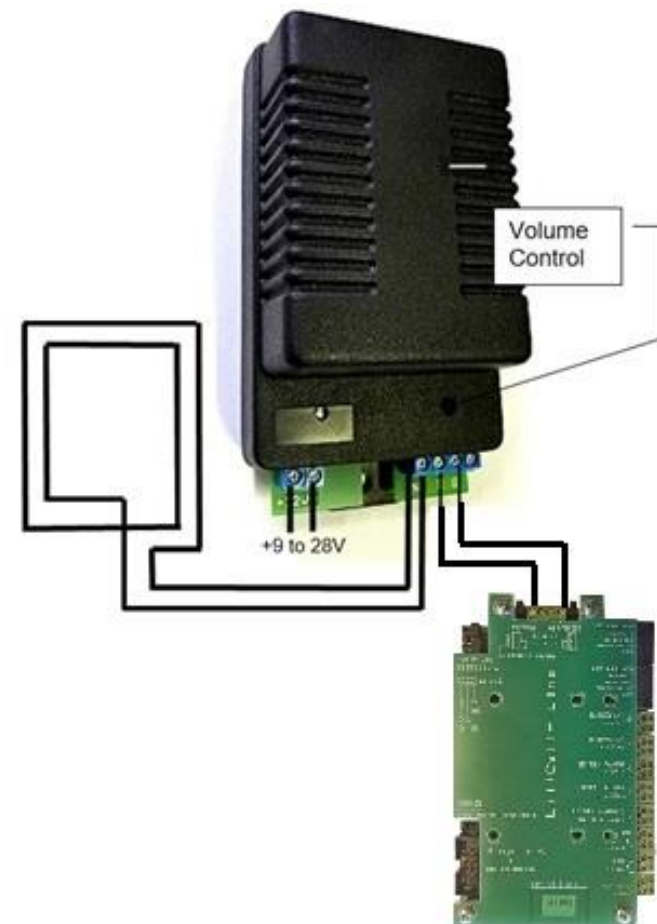



4G Lift Call Line

- The optional Lift Call Line (LCL SPK) speaker/microphone unit
 - outside the lift cabin / elevator car
- 2x LCL SPK - SPK/MIC unit can be installed
 - at the bottom of the lift car and on the lift cabin / car
- Antivandal unit with an emergency call button
- Status LEDs indication – call pickup, call establishing
- Emergency voice connection with the operator, service center, police, etc.





4G Lift Call Line

- The LCL SPK (speaker/microphone) unit is designed for the outside the lift cabin / elevator car
- The LCL SPK unit can be mounted above the lift cabin / elevator car or under the lift cabin / elevator car
- The alarm button is built-in
- Antivandal metal housing for better protection
- Special UTP cable connection to the Lift Call Line emergency intercom
- The special UTP cable is always supplied with the LCL SPK unit

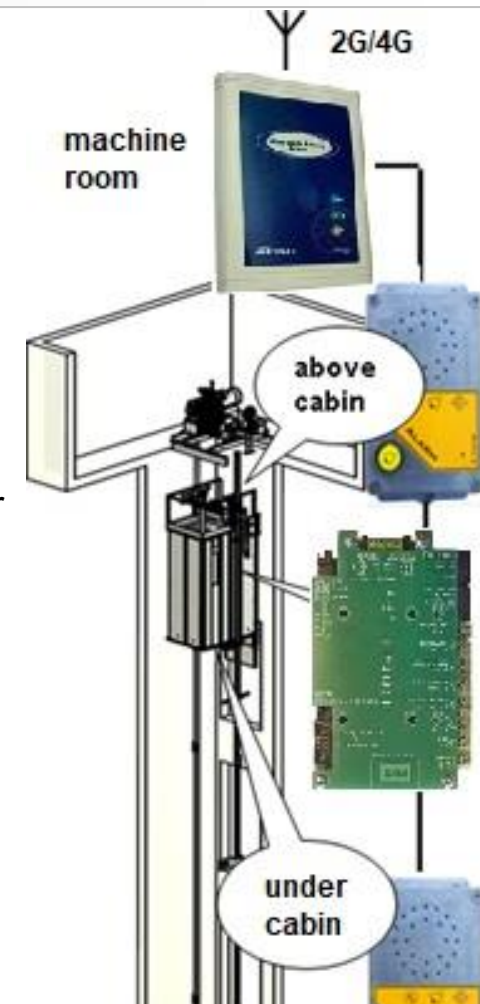



4G Lift Call Line

- The optional SwitchBoard communication unit for the machine room
- For service and installation engineers
- Communication unit between the machine room and 1, 2 or three Lift Call Line units
- Communication between the machine room and the lift cabin / elevator car
- Emergency calls from the lift cabin / elevator call are still active
- External power supply 12-24VDC required

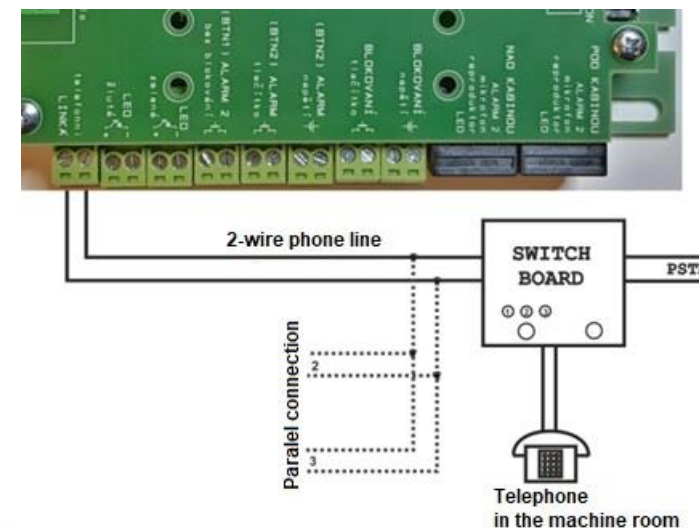
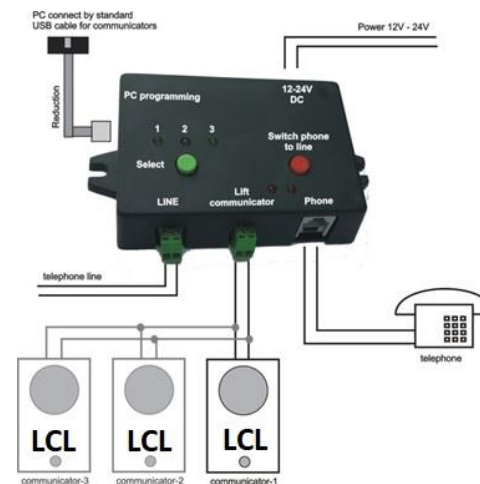



ALPHATECH TECHNOLOGIES s.r.o.

Jeremenkova 88, 140 00 Praha 4-CZ

Tel. +420 244 467 562

<https://www.alphatechtechnologies.cz/>

sales@alphatechtechnologies.cz

